

Y-type Angle Seat Valve

120 Series
Threaded Pneumatic
Angle Seat Valve



120 Series
Welded Pneumatic
Angle Seat Valve



120 Series
Tri-clamp Pneumatic
Angle Seat Valve



Technical Specification

- Operating pressure: 0–16bar (0–232psi)
- Control pressure: 3–8bar (43.5–116psi)
- Control fluid: Neutral gas, Air
- Body material: CF8M/CF8
- Seal material: PTFE
- Actuator material: CF8 (40mm–90mm Actuator)
- Actuator size: 40mm, 50mm, 63mm, 90mm, 125mm
- Applicable fluid: Water, Alcohol, Oil, Fuel, Steam, Neutral gas or Liquid, Organic solvent, Acid and lye
- Fluid viscosity: Max 600mm²/s
- Fluid temperature: –10°C — +180°C (PTFE Normal temperature)
+25°C — +220°C (PTFE High temperature)
- Ambient temperature: –10°C — +80°C
- Control type: Normally closed, Normally open, Double acting
- Connection type: Threaded (BSP, BSPT, NPT),
Welded, Tri-clamp
- Leakage class: EN 12266 Class A

Advantages

- New body seal design can reduce residue and easy to clean
- Large flux, low resistance, no water-hammer
- Y-type shape with enlarged flowing section raises flux by 30% and smoothens the flow.
- Superb service life.
- The stem adjusts and lubricates itself automatically, minimizing needs for maintenance.
- The cylinder can rotate 360° unconstrained, and uses stainless steel material, which enables superior performance.

Order Instruction

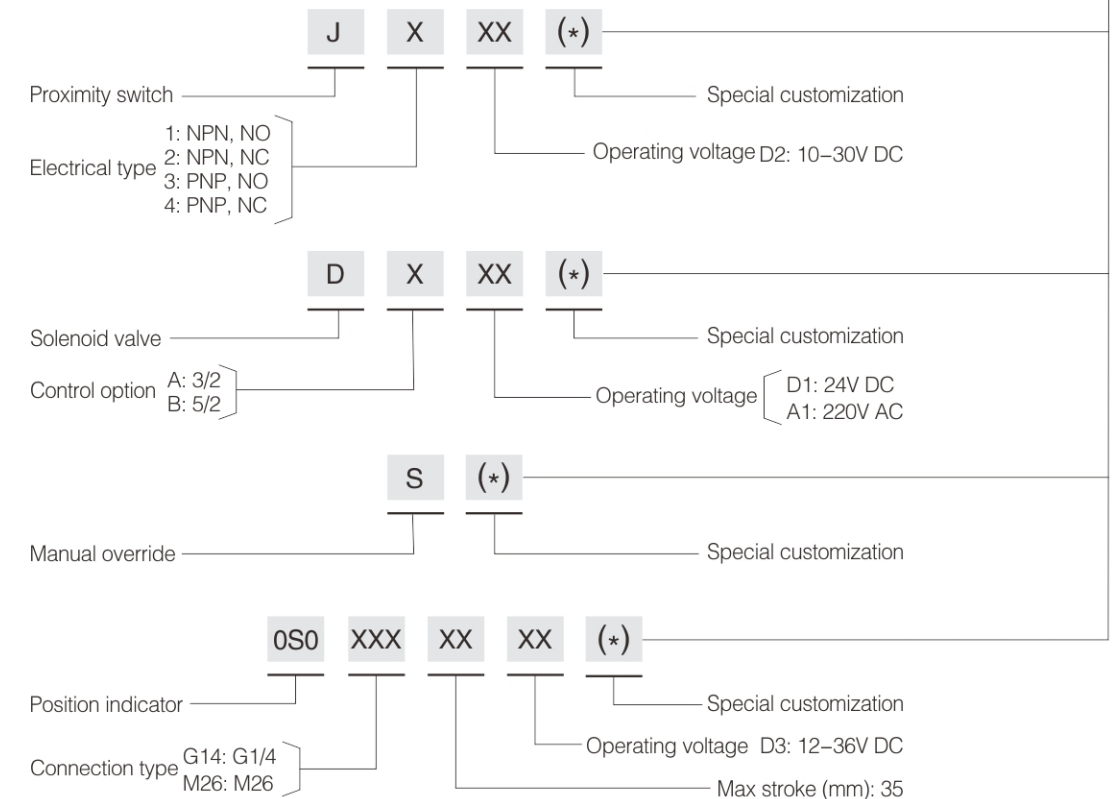
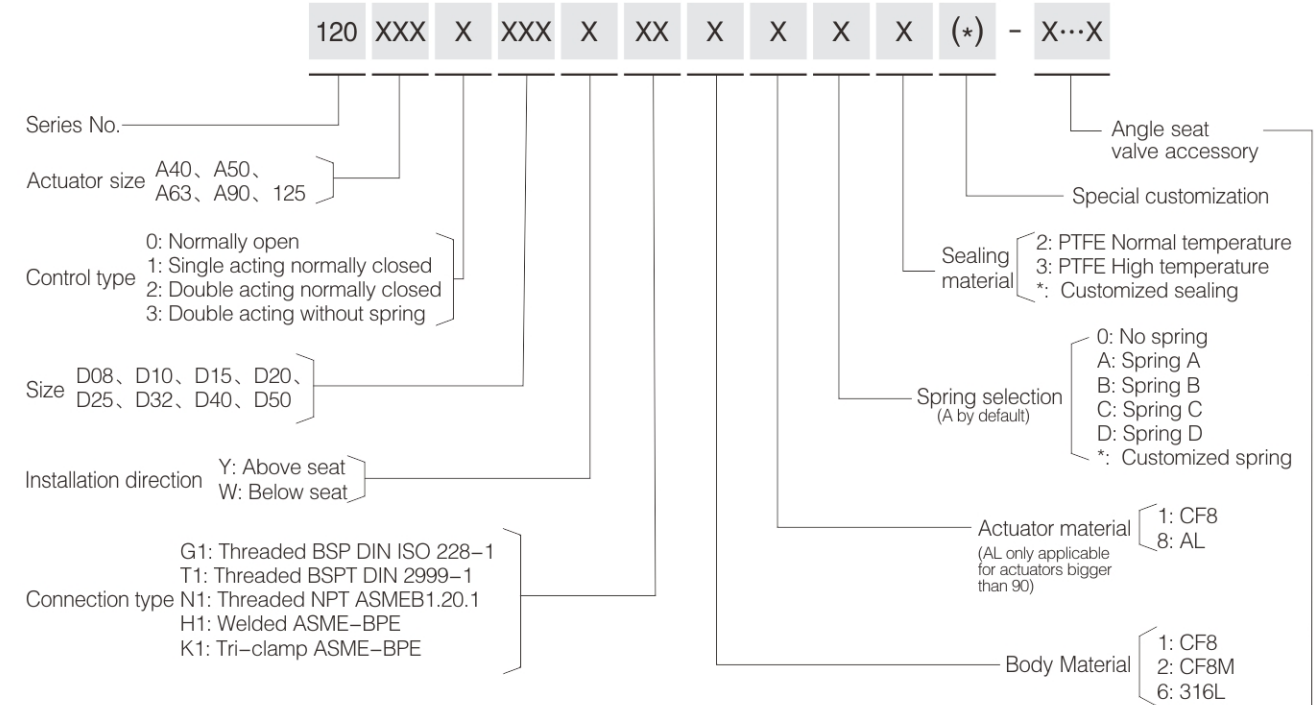

Y-type Angle Seat Valve

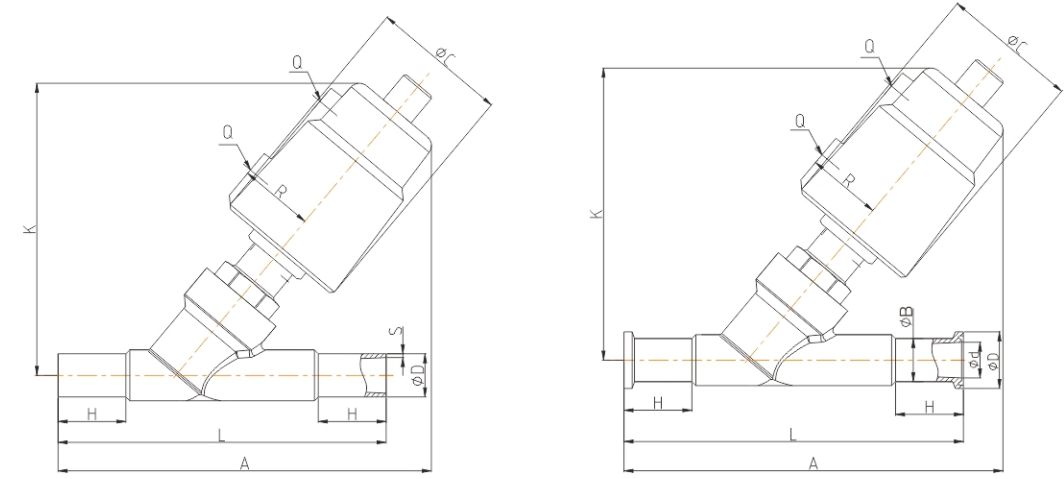
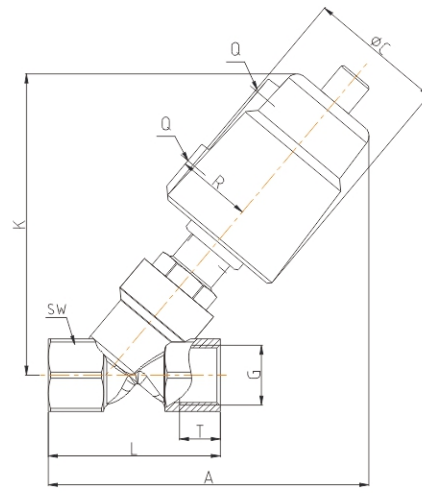

Main Dimension (Threaded Connection)

Size	Actuator (mm)	Q	φC	R	K	A	G	T	L	SW
DN8	40	1/8"	50.5	27	125	131	1/4"	12	65	27
	50	1/8"	60	33	139	143				
DN10	40	1/8"	50.5	27	125	131	3/8"	14	65	27
	50	1/8"	60	33	139	143				
DN15	40	1/8"	50.5	27	125	131	1/2"	16	65	27
	50	1/8"	60	33	139	143				
DN20	50	1/8"	60	33	141	146	3/4"	18	75	32
DN25	50	1/8"	60	33	145	155	1"	20	90	40
	63	1/8"	75	41	167	177				
DN32	63	1/8"	75	41	180	193	1 1/4"	22	110	50
	90	1/8"	106	55	227	235				
DN40	63	1/8"	75	41	180	197	1 1/2"	24	120	56
	90	1/8"	106	55	228	239				
DN50	63	1/8"	75	41	187	215	2"	26	150	69
	90	1/8"	106	55	235	258				
	125AL	1/4"	170	85	300	312				

Main Dimension (Welded Connection)

Size	Actuator (mm)	Q	φC	R	K	A	L	H	ASME BPE	
									φD	S
DN15	40	1/8"	50.5	27	127	155	135	30	12.7	1.65
	50	1/8"	60	33	140	166				
DN20	50	1/8"	60	33	138	170	145	30	19.05	1.65
DN25	50	1/8"	60	33	146	176	152	30	25.4	1.65
	63	1/8"	75	41	168	200				
DN40	63	1/8"	75	41	177	216	182	30	38.1	1.65
	90	1/8"	106	55	225	258				
DN50	63	1/8"	75	41	187	228	210	30	50.8	1.65
	90	1/8"	106	55	235	270				
	125AL	1/4"	170	85	300	325				

Main Dimension (Tri-clamp Connection)

Size	Actuator (mm)	Q	φC	R	K	A	H	L	ASME BPE		
									φD	φB	φd
DN15	40	1/8"	50.5	27	127	158	30	130	25	12.7	9.4
	50	1/8"	60	33	140	169					
DN20	50	1/8"	60	33	138	172	30	150	25	19.05	15.75
DN25	50	1/8"	60	33	146	180	30	160	50.5	25.4	22.1
	63	1/8"	75	41	169	205					
DN40	63	1/8"	75	41	177	225	30	200	50.5	38.1	34.8
	90	1/8"	106	55	225	267					
DN50	63	1/8"	75	41	187	238	30	230	64	50.8	47.5
	90	1/8"	106	55	235	280					
	125AL	1/4"	170	85	300	335					