

Diaphragm Valve

A01 Series
Welded Manual
Diaphragm Valve

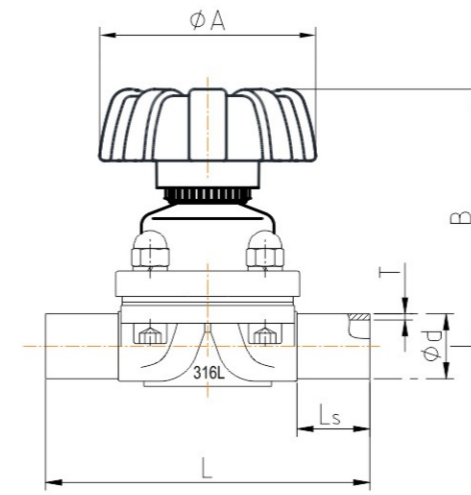

A01 Series
Tri-clamp Manual
Diaphragm Valve



Welded connection

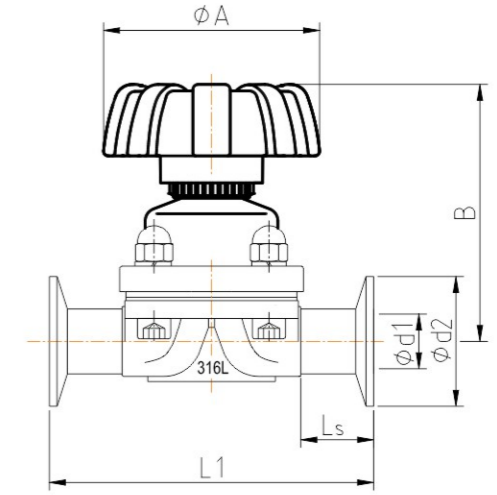

Tri-clamp connection

Main Dimension

Manual diaphragm valve -Weld connection					ASME-BPE	SMS3008	JIS-G3447	ISO-1127	DIN-11850				DIN-11866		
Size	Diaphragm	ΦA	B	L_s	L	$\Phi d \times T$	$\Phi d \times T$	$\Phi d \times T$	$\Phi d \times T$	-0	-1	-2	-3	A	B
DN8	8	40	64	20	72	6.35 × 0.89	-	-	-	-	-	-	-	-	-
DN10	8	40	64	20	72	9.53 × 0.89	-	-	-	-	-	-	-	-	-
DN15	8	50	64	20	72	12.70 × 1.65	-	-	-	-	-	-	-	-	-
	10	65	85	29.5	108	-	-	21.3 × 1.6	18 × 1.5	18 × 1.0	19 × 1.5	20 × 2	19 × 1.5	21.3 × 1.6	
DN20	10	65	85	29.5	108	19.05 × 1.65	-	-	-	-	-	-	-	-	-
	25	85	102	26.5	120	-	-	-	26.9 × 1.6	22 × 1.5	22 × 1.0	23 × 1.5	24 × 2	23 × 1.5	26.9 × 1.6
DN25	25	85	102	26.5	120	25.4 × 1.65	25.0 × 1.2	25.4 × 1.2	33.7 × 2	28 × 1.5	28 × 1.0	29 × 1.5	30 × 2	29 × 1.5	33.7 × 2
DN40	40	105	115	30	153	38.1 × 1.65	38.0 × 1.2	38.1 × 1.2	48.3 × 2	40 × 1.5	40 × 1.0	41 × 1.5	43 × 2	41 × 1.5	48.3 × 2
DN50	50	125	133	30.5	173	50.8 × 1.65	51.0 × 1.2	50.8 × 1.5	60.3 × 2	52 × 1.5	52 × 1.0	53 × 1.5	54 × 2	53 × 1.5	60.3 × 2
DN65	50	125	139	30.5	173	63.5 × 1.65	-	-	-	-	-	-	-	-	-

Manual diaphragm valve -Tri-clamp connection					ASME-BPE		ASME-BPE EN558-1 Series 7		SMS3008		JIS-G3447		ISO-1127		DIN-11850												
Size	Diaphragm	ΦA	B	Φd_1	Φd_2	L_s	L_1	Φd_1	Φd_2	L_s	L_1	Φd_1	Φd_2	L_s	L_1	Φd_1	Φd_2	L_s	L_1	Φd_1	Φd_2	L_s	L_1				
DN8	8	40	64	4.57	25	15.5	63.5	-	-	-	-	-	-	-	-	-	-	-	-	-	-	-	-	-			
DN10	8	40	64	7.75	25	15.5	63.5	-	-	-	-	-	-	-	-	-	-	-	-	-	-	-	-	-			
DN15	8	50	64	9.4	25	15.5	63.5	9.4	25	35	108	-	-	-	-	-	-	-	-	-	-	-	-	-			
	10	65	85	-	-	-	-	-	-	-	-	-	-	-	-	18.1	50.5	29.5	108	16.0	34	29.5	108				
DN20	10	65	85	15.75	25	26.3	101.6	15.75	25	34	117	15.75	25	34	117	-	-	-	-	-	-	-	-	-			
	25	85	102	-	-	-	-	-	-	-	-	-	-	-	-	23.7	50.5	25	117	20.0	34	25	117				
DN25	25	85	102	22.1	50.5	23.5	114.3	22.1	50.5	30	127	22.6	50.5	30	127	23	50.5	30	127	29.7	50.5	30	127	26.0	50.5	30	127
DN40	40	105	115	34.8	50.5	23	139.7	34.8	50.5	33	159	35.6	50.5	33	159	35.7	50.5	33	159	44.3	64	33.5	159	38.0	50.5	33.5	159
DN50	50	125	133	47.5	64	23	158.8	47.5	64	39	190	48.6	64	39	190	47.8	64	39	190	56.3	77.5	39	190	50.0	64	39	190
DN65	50	125	139	60.2	77.5	39	190	-	-	-	-	-	-	-	-	-	-	-	-	-	-	-	-	-	-		

Other specifications available for customization.

Order Instruction

